

# Kempsford

(with Whelford, Dunfield and Dudgrove)

## Parish Newsletter

### September 2023



Car Boot Sale - Kids Games - Raffles - Dog Show - Welly  
Wanging - Ice Cream - Refreshments  
FUN FOR THE WHOLE FAMILY!

# KEMPSFORD PARISH COUNCIL

Clerk: Teresa Griffin, Winterwood, Whelford, Fairford, Glos. GL7 4EB

Tel: 01285 713691 Email: [clerk@kempsfordparishcouncil.net](mailto:clerk@kempsfordparishcouncil.net)

**[www.kempsfordparishcouncil.net](http://www.kempsfordparishcouncil.net)**

Parish Councillors	Email	Tel.
Mr Mark Strange (Chair)	<a href="mailto:markstrange@kempsfordparishcouncil.net">markstrange@kempsfordparishcouncil.net</a>	01285 810635
Mr John O'Connell (Vice-Chair)	<a href="mailto:johnoconnell@kempsfordparishcouncil.net">johnoconnell@kempsfordparishcouncil.net</a>	01285 810512
Mrs Christine Nugent	<a href="mailto:christinenugent@kempsfordparishcouncil.net">christinenugent@kempsfordparishcouncil.net</a>	01285 810306
Mrs Karen Saunders	<a href="mailto:karensaunders@kempsfordparishcouncil.net">karensaunders@kempsfordparishcouncil.net</a>	01285 713155
Mr Neil Green	<a href="mailto:neilgreen@kempsfordparishcouncil.net">neilgreen@kempsfordparishcouncil.net</a>	07745193925
Mr Stephen Andrews	<a href="mailto:stephenandrews@kempsfordparishcouncil.net">stephenandrews@kempsfordparishcouncil.net</a>	01285 719924

## PARISH COUNCIL MEETING DATES

The Parish Council meets monthly at Kempsford Village Hall. Meetings are usually the third Tuesday in the month and start at 7.45pm. Everyone is welcome to attend and a period of time is designated for public participation.

*The next meeting dates are -*  
Tuesday 19th September  
Tuesday 17th October

## OCTOBER 2023 NEWSLETTER

Copy for the above Newsletter to Teresa Griffin by

**MONDAY 25TH SEPTEMBER 2023 PLEASE**

Email: [clerk@kempsfordparishcouncil.net](mailto:clerk@kempsfordparishcouncil.net)

## PARISH COUNCIL NEWS

- ◇ As many of you know, Tony Williams retired as a Parish Councillor earlier this year after serving for 30 years. In recognition of his outstanding service, we will be presenting him with a gift at the Village Fete on Saturday 9th September. It would be great to see you there to show your appreciation.
- ◇ We still have one councillor vacancy to fill by co-option. Councillors will be present at the Village Fete if you are interested in filling this position and would like to discuss.
- ◇ The Parish Council was thrilled to receive a new 'Smiley Face' vehicle activated sign as part of the Gloucestershire County Council Community Speedwatch Fund. Feedback from parishioners has been very positive.
- ◇ Kemsford now has an active Speed Watch Group led by Andy Lee. If anyone is interested in joining the group, please contact Andy on [alee32@btinternet.com](mailto:alee32@btinternet.com)
- ◇ An additional AutoSpeedWatch camera for Whelford has also been provided through the above scheme and we are awaiting installation of a new pole and signage from Gloucestershire Highways. Speeding has always been a problem through Whelford and with the increased traffic due to the Lechlade Bridge closure is even worse. In one hour recently 10 vehicles travelling between 60 and 70mph were recorded, and this is in a 30mph speed limit!

August is normally a quieter month for the Parish Council due to the holiday season. This year it has been a busy month and below is some of the work we have been involved in -

- ◇ Councillors recently attended a 'wash-up' meeting with the RIAT organisers to feedback issues arising from this year's show and how things can be improved in the future.
- ◇ A meeting was held with Kemsford Quarry, and Gloucestershire County Council to discuss their revised restoration plans involving water flows. We await revised plans incorporating our concerns, including taking account of the Whelford Flood Relief Scheme.
- ◇ Councillors are due to meet with our Local Gloucestershire Highways Manager shortly to discuss all highway matters within the Parish.
- ◇ And finally, a meeting has been organised with Gloucestershire County Council and Cotswold District Council Enforcement to discuss the community facilities at Hazel View, Kemsford. As many of you know, the facilities remain in the ownership and responsibility of Persimmon Homes as they have not been constructed to the standard required to be transferred to the Parish Council. The aim of this meeting is to find a way forward to rectify this and complete the transfer.

Please be advised of the following Road Closure - High Street, Kempsford  
This road will be closed (as per the attached plan) from 09:30 to 15:30 on 13/11/23 to allow  
for pole testing work by Openreach.  
Emergency and pedestrian access will be maintained.  
If you should require further information please email [streetworks@gloucestershire.gov.uk](mailto:streetworks@gloucestershire.gov.uk)

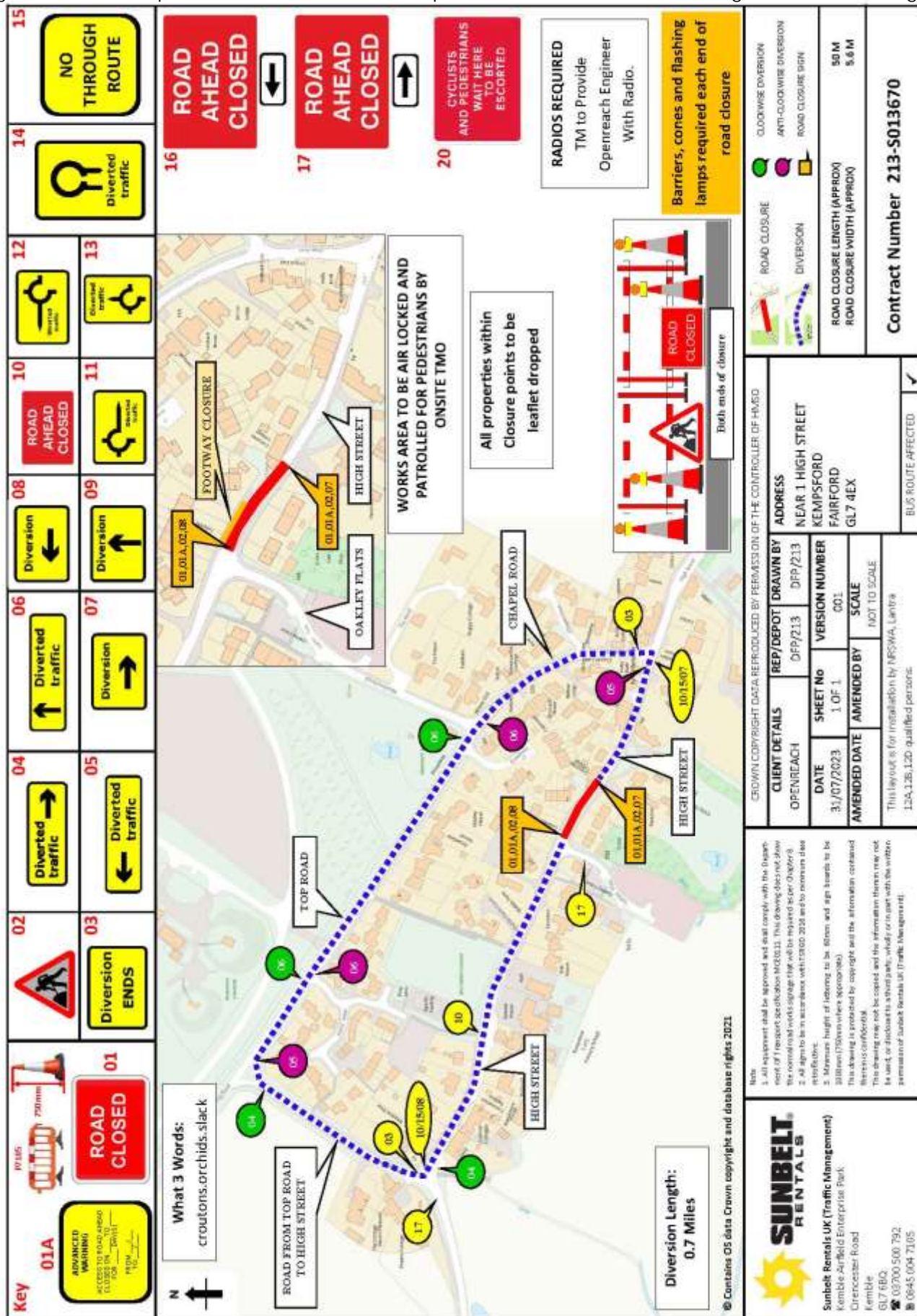

## **Are you struggling with damp and mould in your home?**

Our Research and Campaigns team have been gathering evidence about the problem as we have seen a significant increase in the number of people coming to us about it.

There are many types of damp, the most common ones being rising, penetrating, construction and condensation damp. On our website ([www.citizensadvice.org.uk](http://www.citizensadvice.org.uk)) there is information that may help you work out what type of damp you have, who is responsible and what you can do.

It is important to keep homes well-heated and well-ventilated to prevent damp and mould – you may be eligible for help to insulate and heat your home.

If you are a tenant it can be difficult to work out if your landlord is responsible - check your tenancy agreement for mentions of repairs and damp. A landlord will have to act in relation to damp if it makes the property unsafe for someone to live in. The landlord will also be responsible if the damp is related to repairs they should have carried out. If the damp has damaged items that the landlord is responsible for, such as carpets and window frames, they'll likely have to cover the cost of repairs.

If your landlord is responsible for the damp in your property but doesn't act, there are steps you can take, such as reporting them to the local authority. If you're in social housing you might also be able to use the landlord's formal complaints procedure.

If you cannot access the website or need further help after looking at it, you can contact us on 0808 800 0510 or email using the form on our local website ([www.citizensadvice-stroudandcotswold.org.uk](http://www.citizensadvice-stroudandcotswold.org.uk)).

## Flood Defence

The geology surrounding our villages is predominantly sand and gravel and underneath lies a thick Oxford Clay. When rain falls steadily our natural drainage is very good, the water seeps through the gravel and is absorbed slowly by the clay. Our problems may arise when rain is intense and a lot of water is deposited quickly. This means the clay cannot absorb it quickly enough so the water sits on top and rises through the gravel. Our area has very high groundwater and you do not have to dig down far to find it!

We have in the past had flooding within the villages and recently some very close calls where water has risen across the surrounding fields and got very near to properties. We have the Rivers Coln and Thames very nearby and when they flood there is no natural drainage for the land and groundwater will just rise and rise.

Our worries are also compounded by the complexity of efficiently draining the quarries, any excavation of that size alters the underground flows. We are constantly in dialogue with all the stakeholders to try and ensure this is managed effectively for the long term.

What we ask is you do your bit by not adding excess surface water to the problem. Significant amounts of water enter the drainage systems from our homes and this can be correctly managed by Thames Water. Again, we urge you to ensure all drains are kept clear and guttering is not leaking, this is essential not just for you but all the neighbourhood!

Its mid-summer yet we have seen torrential downpours which the ground cannot handle. Thankfully they have abated without serious implications but we would ask **that you are prepared. There are 'flood sax' available online** which are easy to store and only inflate when saturated. There is plenty of good advice on the Environment Agency website about protection for the home. We all hope none of this is necessary and doing your bit helps us all.



Southrop School PTA  
Registered Charity Number: 104925



# LIVE STAND UP COMEDY

## FRIDAY 22ND SEPTEMBER

**ROGER MONKHOUSE**



Witty wordplay, glorious use of language and killer punchlines

**SCOTT BENNETT**



As seen on LIVE AT THE APOLLO!  
Supported Michael McIntyre  
and Rob Brydon on tour!

**JESSIE NIXON**



Dynamic and erudite jokes with the confidence of a drunk girl in a Wetherspoons toilet!

**COMPERE**



**JAMES COOK**

**TICKETS £10 IN ADVANCE**

**SOUTHROP VILLAGE HALL**

Doors Open at 7 pm

Show starts at 8pm

To book please email

[PTA@southrop.gloucs.sch.uk](mailto:PTA@southrop.gloucs.sch.uk)

Please note line-ups may be subject to change. Our comedians are in high demand and may sometimes have to cancel at short notice for TV or radio recordings etc.

Replacements will always be of a similar standard. Most people come to our shows for a strong overall show, but if you are travelling specifically to see a particular act, please check website on day of show or join our mailing list.



**Britain's biggest professional cycle race, the Tour of Britain, is coming to Gloucestershire this September as the county hosts stage seven of the 2023 race.**



On Saturday, 9 September, the race will start in Tewkesbury and finish in Gloucester. The riders will head east into the Cotswolds, before heading south, then coming up through the Stroud district, and finishing by Gloucester Docks.

We want people from across the county and beyond to come together to support the riders as they ride through the glorious Gloucestershire scenery.

With large parts of the county being covered by the race, it is a brilliant chance to get on the roadside and watch as some of the world's top cyclists race through Gloucestershire.

An interactive map of the route can be found on the [Tour of Britain website](#), with Winchcombe, Cirencester, Tetbury, Dursley and Stroud among the communities welcoming the race.

For more information on the Tour of Britain in Gloucestershire, [visit the county council's website](#).

# A new way to report highways issues – coming soon...



As part of the highways transformation programme we're bringing in a brand new online report it system for highways. The solution is called – **Fix My Street** and it's widely used by many other local authorities across the country. The benefits of the system are:

- It's really easy to use
- Everyone can see live issues so less duplicate reporting
- All reports go straight into the back office getting issues sorted quickly
- Updates provided to customer on how work is progressing
- Clear picture of all the work going on in the county



## What can be reported?

A huge variety of issues can be reported using the interactive map from potholes to damaged traffic lights, broken street lighting, flooding or drainage issues through to road markings or grass verge issues.

## What does this mean for me?

If you regularly report highways issues you need to be aware of the following:

- Phasing out of email - while we will still have telephone support for those that really need it and for emergencies, we want to promote channel shift to this way of reporting as a priority. This will be more efficient and save a lot of time. Therefore, **we'll be phasing out email reporting.**
- Spread the word - if you ever report issues by email or work with organisations who use that channel you can help us by spreading the word to them about this change. **We're also asking anyone that promotes the email address whether it's a councillor, another council we're asking them to get replace the email address with the Fix My Street link when it's ready hopefully in September.**

## Feedback?

**We'd like to know your thoughts on the system once it's gone live and we'll remind you when it does and give you a way to tell us what you think.**

## Kempsford Village Hall booking for the month

	Sunday	Mondays	Tuesdays	Wednesdays	Thursdays	Fridays	Saturdays
AM		10:00 - 11:00 <b>Pilates</b> Rona Bennett 01865 820754	9:00 - 10:00 <b>Yoga</b> Charlie McKenna				
PM				17:30 - 18:30 <b>Youth Club</b> (Term time only)	12:00 - 14:00 <b>Post Office</b> <b>Monthly Café</b> (Café 2nd Thurs of the month)		
Evening			20:00 - 21:30 <b>Village Hall Meeting</b> (monthly, 2nd Tuesday)				
			19:45 - 21:45 <b>Parish Council Meeting</b> (monthly, 3rd Tuesday)				

### KEMPSFORD VILLAGE HALL COMMITTEE MEMBERS

\*Ian Housley, Chair

\*Kathy Woodward, Secretary

\*Andy Gray, Treasurer

\*Jo Colson

Luke Fry, Joint Bookings Secretary

Molly Pekarik Fry, Joint Bookings Secretary

Karen Saunders, Parish Council Rep

Cassie Vickery-Cummings

Hannah Dickens

Jacquie Howlett

*\* Denotes Trustee*

To contact any Committee Member email [infokempsfordvillagehall@kempsford.net](mailto:infokempsfordvillagehall@kempsford.net)

New members are always welcome!

The **Kempsford Village** Facebook Group is a great way to keep up to date with all events and news in the Parish



**Kempsford Village**





KEMPSFORD VILLAGE FETE

# FUN DOG SHOW

Best Puppy 0-2 years

Best Veteran 7+ years

Most Handsome/Prettiest

Waggiest Tail

Best Junior Handler

Dog Judge would most like to take home

Winners Entered in Best in Show -

Sponsored by Kaz Kare

£2 per class - Rosettes for all participants

Plus more games - £1

September 9th

Fete 12pm-3pm ~ Dog Show 1pm

Kempsford Village Hall & Sports Field

Advanced entries by email to:

[infokempsfordvillagehall@kempsford.net](mailto:infokempsfordvillagehall@kempsford.net)





KEMPSFORD VILLAGE HALL CAFÉ  
Thursday 14<sup>th</sup> September 12 – 2pm

Locally produced Ham and Cheese Ploughmans,  
Homemade Soup and Bread, Delicious Cakes,  
Fresh Coffee and Speciality Teas.

All welcome  
If you haven't been before you're missing a treat!

## Whelford Village Hall

(Registered Charity No. 301648)

**FREE** fast broadband available to all Hirers

**For bookings, contact Sue Griffin on 01285 712979 or  
email: [374croft@gmail.com](mailto:374croft@gmail.com)**



## TEMPORARY ROAD CLOSURE FOR VILLAGE FETE

Please note that Kempsford Village Hall Committee would like to give notice of closure of the high street from the entrance to the Village Hall to the footpath between the school and Hazel View. This will take place on 9<sup>TH</sup> SEPTEMBER BETWEEN 10.30am AND 15.30pm. This is for the purpose of safe crossing of this street by the public during the Village fete.



Kempsford Village Hall

**Bingo**

Saturday 30<sup>th</sup> September 2023

Doors open 5.30pm for eyes down 6.00pm

Refreshments available – Cash prizes-Raffle

# ST MARY'S KEMPSFORD WITH ST ANNE'S WHELFORD

## Contact details for the parish

Rev Kim Brown - 01285 810954 or [revkimbrown10a@gmail.com](mailto:revkimbrown10a@gmail.com)

Lay Preacher – Rob Mitchell 01285 712821

Church wardens: Elizabeth Emberson [dizzylizzie@sky.com](mailto:dizzylizzie@sky.com)

or Keith Howlett - 01285 712268 [churchwarden@kempsford.net](mailto:churchwarden@kempsford.net)

or there is a Facebook page The 5 Villages

Autumn is almost upon us as I write. For many, September is the start of the new school year; all that new uniform, shoes and PE kits to be sorted out (if you need any help with that this year, please contact me. There are funds to support people of the village with these costs). For young people collecting results it can feel a make-or-break time, but **there are lots of new paths you can explore if the one you were expecting doesn't work** out first time. Learning and education are a life-long journey, and not all decided in one results day.

Our youth club is being renewed this September; we have so many children coming now, we are splitting into two age groups so everyone has enough room – and to spare all our eardrums! The new groups will be as follows: School years 4-6 will meet 5pm to 6.15pm each Wednesday in the Village Hall, and School years 6-8 meet 6.15pm to 7.30pm. We gratefully welcome Vicki Wyborn who will join our team with the older group in September.

Another young person from our village doing something new this September is Dan Strange. Dan has been learning to play the church organ and doing it to a brilliant **standard. He has kindly offered to play his first public concert at St. Mary's on Friday 22<sup>nd</sup>** September at 7pm, in aid of our toilet appeal, along with some other first-rate performers. Tickets are £5, from **me tel 810954, Ann O'Hara in Kempsford tel 810800 or Jacqui Howlett** in Whelford tel 712268. Please do get your tickets and come along for a great night, and there will be a bar.

The new community garden behind the village hall is now up and running and everyone is invited to come down, to help a little and enjoy the space. Food is beginning to grow, and new beds are being made and seeds sown. It is a very restful space and the people very friendly. The next drop in gardening sessions are from 1.30pm to 4.30pm on Sat 30<sup>th</sup> Sept and Sat 21<sup>st</sup> Oct. The upcoming jobs will be:

- Clearing the space for a greenhouse to raise plants from seed next year.
- Making another compost bin from pallets
- Building further vegetable beds to grow vegetables next year
- Preparing the ground for a mixed flower border

My fruit trees are burgeoning from all that sun and rain and there are baskets of fruit outside the Parsonage, so please help yourself and enjoy some crumbles! Whatever you are doing this autumn, may you be blessed and flourish. With love, Rev Kim

## St Mary's, Kempford with St Anne's, Whelford

### Church Services

Sunday 3 September	9.30 am Kempford	Holy Communion
Sunday 10 September	9.30 am Kempford	Service of the Word
Sunday 17 September	9.30 am Whelford	Holy Communion with Harvest Festival
	4 pm Kempford	Family Service Harvest
Sunday 24 September	9.30 am Kempford	Holy Communion with Harvest Festival

St Mary's is open every day and St Anne's on Fridays for prayer and reflection.

\*\*\*\*\*

### Food Bank

We continue to collect donations for the food bank. Boxes are in place outside **both St Mary's and St Anne's in the porches** and are emptied regularly and the contents taken up to Cirencester to the warehouse.

Particularly needed are long life fruit juice, vegetarian foodstuffs, tinned veg particularly tinned tomatoes, tinned fruit, long life milk, tinned sponge puddings and custard.

(Baby formula, medicines and dietary supplements cannot be accepted and they **don't need any more** baked beans, pasta, rice and soup at present.)

Thank you to all who donate so generously.

### TEAMS 4 U CHRISTMAS BOXES

It is not too early to start collecting items (with the summer sales now on) or starting to knit hats, gloves and scarves. I shall be collecting shoe boxes again this year in November to send to disadvantaged children in UK and Europe.

Rosemary Andrews

## **Lechlade History Society**

Lechlade History Society's speaker for Monday October 16th 2003 Ian Boskett is talking to us on The Great Train Robbery 1963

Ian will be presenting an illustrated talk including police files and family members' stories, and with a 1960 signal shows us how the robbers stopped the train whilst it was travelling at 95 mph, we will hear about the train driver, the police and general odds and ends

Lechlade Memorial Hall 7.30 pm doors open at 7pm for tea and coffee

---

### SHORT MAT BOWLS

I am trying to ascertain if there is any interest for the above activity at the Kempsford Village Hall?

Players of all abilities would be welcome, I am a beginner myself.

Please email me on [agray311@btinternet.com](mailto:agray311@btinternet.com)

### Table Tennis

There is currently a TT club on Thursday evenings 8.00 – 9.00pm at the school hall. Any adults interested please just come along and give it a try.

PS: we do go for refreshments afterwards at the OSC.



## FRIENDS OF FAIRFORD & LECHLADE COMMUNITIES

Serving Fairford, Lechlade and the surrounding villages.



News and Information from your Community Friends

### DATES FOR YOUR DIARY

Join us on Saturday 7<sup>th</sup> October 19:00 for a Fundraising restaurant night at the Trout Inn, Lechlade. £26 for a main and desert, drinks not included. To book or for the menu choices, call 07540 798 226 (Transport line) or 01367 252706 (Ruth), or email [transport@friendsoffairford.org.uk](mailto:transport@friendsoffairford.org.uk)

Our next Quiz and Chilli Night will be on Friday 20<sup>th</sup> October (doors 7pm, quiz starts 7:30pm), £10 per head, includes meal. Tables of 6 – 8. Please book by email to [admin@friendsoffairford.org.uk](mailto:admin@friendsoffairford.org.uk).

### STAFF VACANCY: ADMINISTRATOR

We are hiring for an Administrator. This is a paid role, 5-7 hours a week. For more information, please see the details on our website or get in touch with Kerry on [admin@friendsoffairford.org.uk](mailto:admin@friendsoffairford.org.uk). Application deadline 1<sup>st</sup> October.

### VOLUNTEER VACANCIES: TRUSTEES

Can you help us in the governance of the charity? We are seeking new Trustees to take on the Chair and Vice Chair roles, and for Trustees to take responsibility for various Subcommittees. For more information or to discuss, please contact Shelley on [chair@friendsoffairford.org.uk](mailto:chair@friendsoffairford.org.uk)

### CHARITY RECIPE BOOK

**Want to see your name in print? We're creating a Community Recipe Book! We'd love submissions of your favourite personal and 'secret' family recipes (images welcome too!).** Books will be available to purchase before the end of the year. Please send submissions to Kerry at [admin@friendsoffairford.org.uk](mailto:admin@friendsoffairford.org.uk)

### EDNA DAWES LUNCH CLUB

Our much-loved Edna Dawes Lunch Club provides a hot meal, activities and social interaction for isolated elderly people. Transport can be provided. We are hoping to reopen on Mondays so if you are interested or know someone that would like to attend, please do get in touch with Katie our Lunch Club Team Leader: [edlc@friendsoffairford.org.uk](mailto:edlc@friendsoffairford.org.uk) / 07713 607106.

## PATIENT TRANSPORT SERVICE

Our volunteer car service vital service is a lifeline to many and our wonderful volunteer drivers provide a personal service for a very low cost. There is a small fee to cover the **volunteer's fuel and running costs. We would** welcome more volunteers, please do get in touch if you can assist.

To arrange a journey or if you think you can help people get to their medical appointments, please get in touch with Val on [transport@friendsoffairford.org.uk](mailto:transport@friendsoffairford.org.uk) / 07540 798226.

## BEREAVEMENT CAFE

We continue to run our Bereavement Café on the first Friday of every month, for people who have suffered a loss and would like to talk. Our nursing team will be present to welcome you with a hot drink and some refreshments. Please do drop in, between 10:00 and 12:00 at The Barker Room, Fairford Community Centre. If you have any questions, please call 07938244335 or email [admin@friendsoffairford.org.uk](mailto:admin@friendsoffairford.org.uk)

## HOW TO CONTACT US

Chair: Shelley	<a href="mailto:chair@friendsoffairford.org.uk">chair@friendsoffairford.org.uk</a>	
General Manager: Kelly	<a href="mailto:gm@friendsoffairford.org.uk">gm@friendsoffairford.org.uk</a>	
Administrator: Kerry	<a href="mailto:admin@friendsoffairford.org.uk">admin@friendsoffairford.org.uk</a>	01285 707300
Patient Transport: Val	<a href="mailto:transport@friendsoffairford.org.uk">transport@friendsoffairford.org.uk</a>	07540 798226
Nursing Team: Emma and Jan	<a href="mailto:nursing@friendsoffairford.org.uk">nursing@friendsoffairford.org.uk</a>	07938 244335
Charity Shop: Linda	<a href="mailto:shop@friendsoffairford.org.uk">shop@friendsoffairford.org.uk</a>	01367 252189
Edna Dawes Lunch Club: Katie	<a href="mailto:edlc@friendsoffairford.org.uk">edlc@friendsoffairford.org.uk</a>	07713 607106
Website	<a href="http://www.friendsoffairford.org.uk">www.friendsoffairford.org.uk</a>	

## HOW TO DONATE

If you would like to make a donation you can do so online through our website [www.friendsoffairford.org.uk](http://www.friendsoffairford.org.uk) or by sending cheques made out to 'Friends of Fairford' and posting to Friends of Fairford & Lechlade Communities Charity Shop, Lloyds Chambers, High Street, Lechlade, Glos GL7 3AE. **If you are able, we'd really appreciate it if you could complete a Gift Aid Declaration so we can claim an additional 25% of your donation from HMRC.** Forms can be found on our website.

---

Information on what we do can be found on our website [www.friendsoffairford.org.uk](http://www.friendsoffairford.org.uk) and **the names of our existing team of trustees are listed on the Charity Commission's website.** Friends of Fairford & Lechlade Communities (Reg. Charity No. 1180059)



It can be life-changing for a young person to have a trusted independent adult to talk to. This is especially true for those referred to Gloucestershire Mentoring Programme, a service that trains and supports volunteer mentors to fulfil this role. Demand for the service is high and the organisers are currently looking to expand their pool of volunteers – locals who are empowering young people in **their communities to make positive changes and realise their potential**. If you're interested and would like to find out more, the organisers would be pleased to see you at their online information event on 20th September, 7 – 8pm. You can sign up via the GMP website at [www.gloucestershirementoringprogramme.co.uk](http://www.gloucestershirementoringprogramme.co.uk)

Gloucestershire Mentoring Programme is run by a collaboration of trusted organisations and hosted by The Door. It supports 10 – 25 year old girls and young women whose life circumstances suggest **they're at risk of becoming involved in crime**. This can be because they've had Adverse Childhood Experiences or live in environments that are known to put them at risk, or because they've become linked to criminal activity, either as victims of crime or through relationships with offenders.

The Programme operates **across Gloucestershire and South Gloucestershire** and offers these "at risk" young people the chance to form a long-lasting relationship with a trained volunteer mentor. This **relationship with a trusted adult is something that's often been missing in the** lives of such young people, and it can be transformational.

Anyone can become a mentor. You just need a heart for understanding and supporting young people **and a little spare time (about an hour or so a week)**. **Full training is provided**. If you'd like to get on board straight away, please email [info@gloucestershirementoringprogramme.co.uk](mailto:info@gloucestershirementoringprogramme.co.uk)

Gloucestershire Mentoring Programme is offered free of charge, thanks to funding from CHK Foundation. For more information visit [www.gloucestershirementoringprogramme.co.uk](http://www.gloucestershirementoringprogramme.co.uk)



Friends of Kempford invite you to our

# TUG OF WAR COMPETITION

This will be held on the playing field during the village fete on 9th Sept @ 12noon. Prize for the winning team!

Please register in teams of 5. Teams can be mixed gender and must have a team name. Team entries need to be registered to Mrs Carmen Ballard by 4<sup>th</sup> September. Please email:

[Cballard@kempford.gloucs.sch.uk](mailto:Cballard@kempford.gloucs.sch.uk) to enter.

Team fees are £10 cash on the day (£2 per person). All monies raised goes to Friends of Kempford school and every child will benefit. Thank you for your support!



## Kempsford Community Garden

Thank you to Jim and Cally Arkell for the materials **for the children's den area, to the Musson family** for the shed and bench and to Ruth Gray for the money from the Plant Sales.

The next working parties are to be held on Saturday 30th September and Saturday 21st October in the garden behind Kempsford village hall between 1:30pm and 4pm.

Please come along with your tools and help us develop the space into a beautiful and productive garden. In the next sessions we will be preparing further areas to grow vegetables and preparing the ground for a flower border.

We have been donated brick Pavers for the patio area but are looking for a man with access to a minidigger to help us with this project. Can you help?

If you have any garden tools which you no longer need and are willing to donate please contact either Kathy Woodward on 07821540088 or Jacqui Howlett on 01285 712268

*Do you produce anything for or from the garden?*

*Eg Honey, Chutneys or wooden tools*

*Do you produce eco-friendly sustainable products?*

*Do you practise a rural craft?*

*If so please contact Jacqui on 01285 712268 to discuss having a stall at the Autumn Plant Swap.*

### **Don't lose your vote – residents in the Cotswolds urged to check voter registration details**



Cotswold District residents are being urged to check their electoral registration details or risk losing their chance to vote on decisions that affect them as the Council starts its Annual Canvass to check everyone's voting details are up to date.

With Police and Crime Commissioner elections taking place in 2024 and a general election due to be called before 17 December 2024, this is an opportunity for residents to make sure they can take part.

Residents can find out more about elections on the website at [cotswold.gov.uk/elections](https://cotswold.gov.uk/elections). Anyone with **questions about their registration status can contact the council's electoral services team at** [Elections@cotswold.gov.uk](mailto:Elections@cotswold.gov.uk) or by calling 01285 623002.



Kempsford Community Gardeners



## Autumn Plant Swap



At Kempsford Village Hall  
Saturday 14th October, 12am—4pm

Swap your excess garden plants with others or  
donate them for us to sell (seedlings, transplants etc)  
Plants may be dropped off from 11am , please label them.

Buy new plants for your garden  
Refreshments available



Further information:

Email: [Jacqui.howlett@btopenworld.com](mailto:Jacqui.howlett@btopenworld.com) or phone 01285 712268

Kempsford Community Gardeners

## **Design Our Logo Competition**

**Calling all budding artists and graphic designers.**

**Brief:** Design a logo for our developing community garden where people can meet up, grow vegetables to share with others and encourage wildlife in a peaceful beautiful garden.

**Age Categories :** 5—11 , 11-15, 16 and over

**How to enter:**

Email: [jacqui.howlett@btopenworld.com](mailto:jacqui.howlett@btopenworld.com) or phone 01285 712268 to obtain your entry number.

Create your original colourful piece of art on A4 paper using crayons, felt pens or paint.

Include your first name and entry number on the back.

Leave your entry at the Village Hall Post Office any Thursday **before 7th September 2023** between 12 and 2pm

Entries will be judged and prizes awarded at the Village Fete on Saturday 9th September

# *Gifts & More Craft Fair*

*Kempsford Village Hall*

*Saturday 4th November*

*Opens 10.30am*

*Closes 3.30pm*

Wide range  
of products

New stalls  
added for  
2023

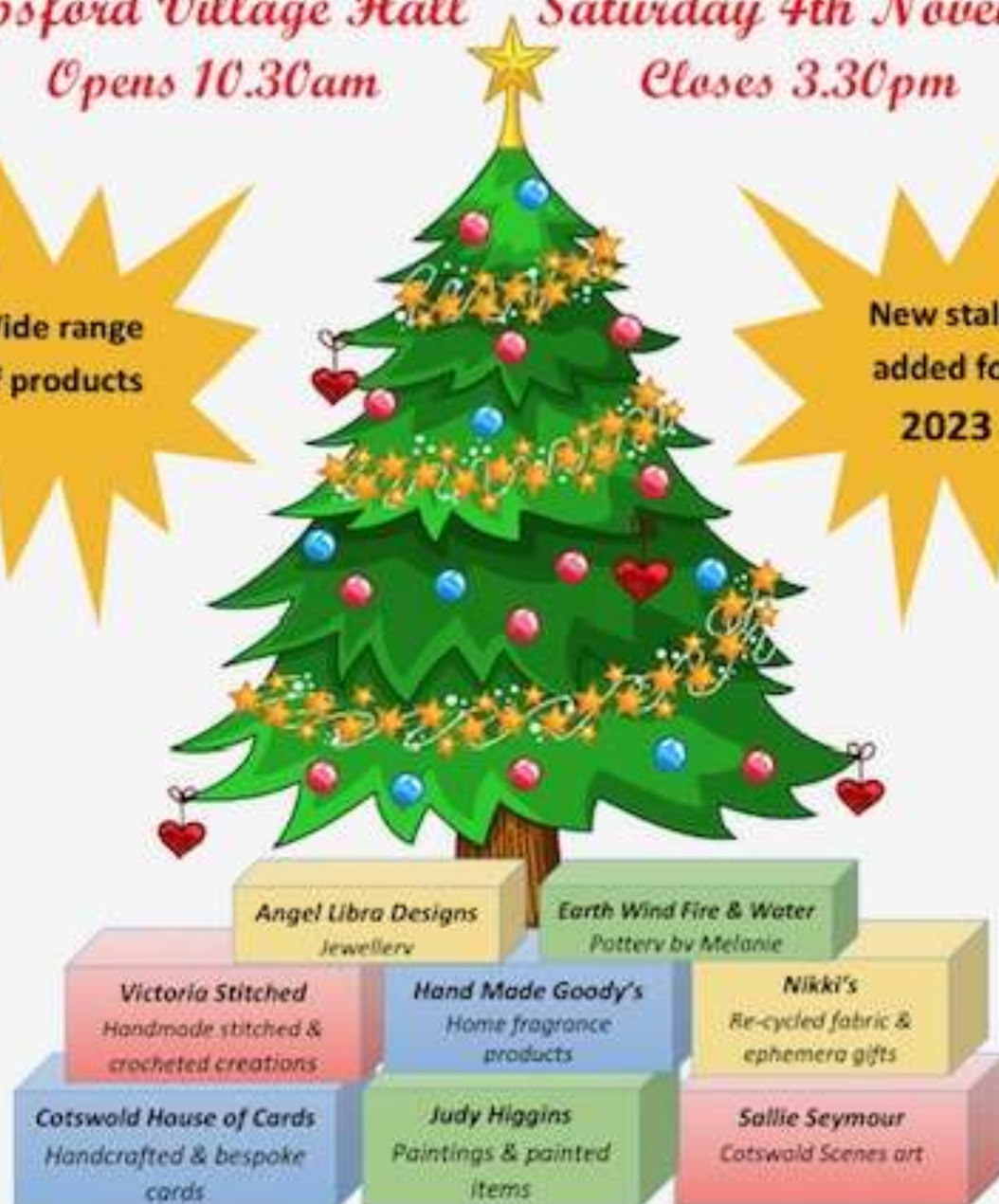

Organised by Kempford and Whelford PCC

Raising funds to support the church in the community and to improve facilities at our churches for services, community events and celebrations.

# GOLF DAY

RAISING FUNDS FOR

**CIRENCESTER MALE VOICE  
CHOIR**

**OAKSEY GOLF CLUB  
FRIDAY SEPTEMBER 29**

FIRST TEE AT 9.30AM

**TEAMS OF FOUR WITH BEST  
THREE SCORES ON EACH HOLE  
TO COUNT**

**PRIZES FOR TEAMS AND  
INDIVIDUALS**

**£40 PER PERSON**

**BREAKFAST ROLL ON ARRIVAL  
ONE COURSE LUNCH INCLUDED**

TO BOOK, EMAIL:

[golf@cirencestermvc.co.uk](mailto:golf@cirencestermvc.co.uk)

Or call 07468 490031

Cirencester MVC is a Registered Charity - 1199094



# LOGS FOR SALE

The Cotswold Canals Trust provides a delivery service of seasoned Ash logs for wood burners and open fires

Delivery is available within a 16 mile radius of Driffield

The Trust is a charity and exists to progress the restoration of the Cotswold canals. If you support this ambition, or would just like some logs, please visit [www.cotswoldcanals.org/support-us/log-sales](http://www.cotswoldcanals.org/support-us/log-sales) or call 01453 752568 for details

Your support will directly help the restoration of the Thames and Severn Canal and Stroudwater Navigation



## Friends Against Scams - FREE Call Blockers



Do you want more confidence in answering your landline or do you know somebody who receives scam or nuisance calls?

From Monday 14th August, and in partnership with TrueCall, Friends Against Scams are offering FREE call blocking units to those receiving scam and nuisance calls.

The call blocker project started in 2019 resulting in a big reduction in scam calls and greater wellbeing for users:

- **Over 91% of scam and nuisance calls were blocked**
- **99% of applicants felt happier 😊** that they no longer receive scam or nuisance calls

You can apply for a free call blocker from Monday 14th August.

Follow the link and keep up to date with the latest scams at [www.friendsagainstscams.org.uk/scam-alert](http://www.friendsagainstscams.org.uk/scam-alert)

## Village Organisations & Useful Contacts

Vicar	Rev Kim Brown	revkimbrown10a@gmail.com	01285 810954
Church Wardens	Keith Howlett	churchwarden@kempsford.net	01285 712268
	Elizabeth Emberson	dizzylizzy@sky.com	
Church Choir	Mrs Cathy Stanford		713033
Church Bells	Iris Lewis		810770
Kempsford School		admin@kempsford.gloucs.sch.uk	810367
Chairman of School Governors	Darren Jeffrey	chair@kempsford.gloucs.sch.uk	810875
Farmors School	Mr Matthew Evans (Head)		712302
Kempsford Village Hall Bookings	Luke Fry	villagehallbookings@kempsford.net	
Whelford Village Hall & bookings	Sue Griffin	374croft@gmail.com	712979
Kempsford Brownies	Now closed	https://www.girlguiding.org.uk/	
Cricket	Anthony Axel-Berg		07766222951
Royal British Legion	Mr A Hill		810035
Scottish & Southern Electricity		Reporting of power cuts	105 0800 072 7282
Thames Water			0800 316 9800
Non-emergency Police Contact			101
NHS 111 Service		(when less urgent than 999)	111
Environment Agency	Floodline—0845 9881188	General Enquiries -	03708 506 506
Bulk Refuse	(phone to book)		01285 623000
Highway Matters & Street Light Faults	GLOUCESTERSHIRE	highways@gloucestershire.gov.uk	08000 514 514
	WILTSHIRE	northernhighways@wiltshire.gov.uk	0300 456 0105
Kempsford Hand Bell Team (Beaubells)	Iris Lewis		01285 810770
Cotswold District Councillors	Clare Muir Helene Mansilla	clare.muir@cotswold.gov.uk helene.mansilla@cotswold.gov.uk	
Cotswold District Council			623000
Gloucestershire County Council			01452 425000
		Out of hours <u>Social Care issues only</u>	01452 614194
Gloucestershire County Councillor	Mr Dom Morris	Dominic.morris@gloucestershire.gov.uk	07500894702
Constituency MP	Sir Geoffrey Clifton Brown	cliftonbrowng@parliament.uk	01242 514551
Parish Council Clerk (see Parish Council page for Councillors)	Mrs Teresa Griffin	teresagriffin@kempsfordparishcouncil.net	0781 8626158
Newsletter items	Mrs Teresa Griffin	As above	0781 8626158
Kempsford Website		www.kempsford.net	
Kempsford Parish Council Website		www.kempsfordparishcouncil.net	

Kempsford

**Online**



'Kempsford Village'  
'Kempsford Mums & Dads'

**Friday 22<sup>nd</sup> September 2023**

# ***Musical Celebration***



***All ages welcome***

***Enjoy the music of classical,  
modern, jazz and pop composers***

**St Mary's Church Kempford**

**Doors open 6.30pm – 7.00pm start**

**Event bar**

**Adults £5; accompanied children free entry**

**Tickets on sale now from:**

**Kim : 01285 810954**

**Jacqui: 01285 712268**

**Ann: 07760 272224**